



IJSLANDER



ADVANTAGES

- ✓ Developed in collaboration with TNO and Top Health Partners physiotherapists.
- ✓ EPDM rubber is also available in black.
- ✓ TÜV certified.

FIFTY+ STEPPER FIT4LIFE

Article: 1373

The Fifty+ Stepper has two footrests and a support rail for a comfortable position. The exercise on this equipment consists of stepping. The exercise focuses on cardio and muscle groups of the upper and lower legs and is suitable for seniors. The Fifty+ Stepper is standard equipped with blue EPDM on the support handle and footrests.

[Read more on our website](#)

SPECIFICATIONS



Fall height

0.27m



Safe zone

3.9m x 3.8m



Total weight

55 kg



Measurement

0.89m x 0.78m x 1.36m



Play value

Socialising,
Suppleness, Agility, Muscle
strength, Exercise, Sports
activities, Outdoor fitness, Cardio,



Age

16 - 99



Heaviest part

33 kg



Montage

4



Materials

RVS (buis 42,4x3 en 33,7x2mm,
plaat 2500x1250x3mm, koker
80x...

Veilige zone

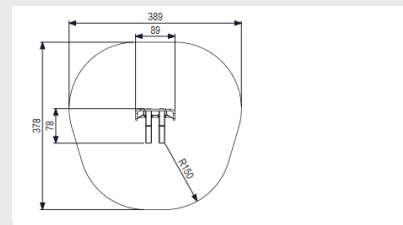



IJSLANDER

IMPRESSION

